

: 8. ! +2 ' ; 4 5; +7 6+7 9548' 4* 88+3 (2 4897.) 9548

"& /
EE7? 4K
, E397 3D
GF@! 7;9: F 6GF? 7GE
%A 7D 367 6GF? 7GE
*: 3D7@@ "GF@FA@
%A 7D 3DE

" #&! \$ "
N) 736 3>: @FBFA@; @F; E? 3@B> 478D CE@
? A 7D
N" @B75FA@D@ @AD@ @674DEAD@D; 9@
A475E3@ D? A7 F?? 478D ? A ; @
N&7HDB357 KAGD. 3@E 8@7DE AD87F; @E67
F7 D7> : F AG: @FBA 7D6 4K3 ? AFAD1 : 7@
F7 I : 77EFGD@F7 D7>5GE
N&7HD? A I : 7@F7 9@EE; EI 7F7 @G: FA47
E; BB7DK
N A@FB357 KAGD. 3@EAD87F@3DB ? A; @
B3DF8F7 ? A 7D
N A@FAB7D3F F7 ? A 7D I ; : 7 43D78AFAD
I 73D@ E@3E
N. 3> EA * @H7D@ @ 3KE47 EG7 A8KAGD
8AF; @ I : 7@AB7D3F@ F7 ? A 7D
N&7HD; @7 @A@ * KEE=7 AD@? H77E 8 @7E
7F5 +; : E53@53GE7 ; @G7E ADE7HD * K63? 397
F7 ? A 7D
N) 7? 7? 47DF 3FF; E? A 7D; E3 BD75EA@B757
A8@I @53D7 7CGB? 7@ +D73F; F3EEG5: 4K
7J7D; E @ 53GFA@ : 7@GE @; F
N%3=7 EG7 KAGD? A 7DE; @E87 AB7D3F@
5A@; FA@ A@F3H? BFA AB7D3F F7 ? A 7D; 8
; F; E63? 3976 : 3H ; FD7B; D76 8DF

- PACKING LIST:**
- 1. Reel mower
 - 2. T-Style 4pc Handles (see Figure 1)
 - 3. Instruction Manual and Grips
 - 4. Assembly Hardware Package:
 - Catcher Hook
 - Wing Nuts
 - M6x55 Handle Bolt
 - Washers
 - M6x45 Handle Bolt
 - "E" Rings

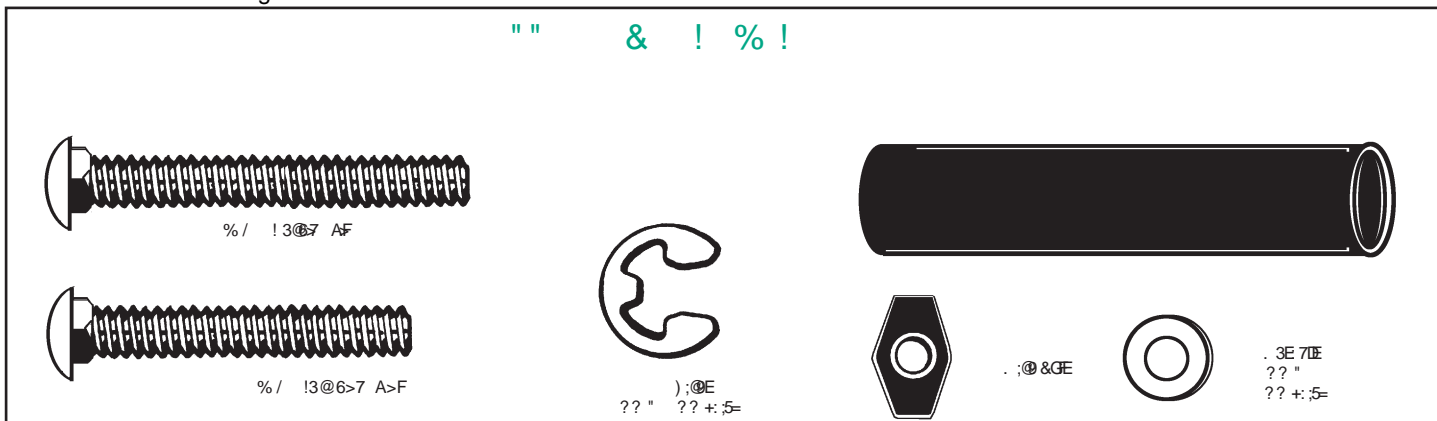

PLEASE MAKE SURE YOU HAVE ALL THESE PARTS BEFORE YOU START.

' 4* 2-
 @AE76 ; @63DA@3D7 F7 ? AI 7D 3@7 B3DE
 BB7D 3@743DB;757E3@ AI 7DB;757E 3@
 : 3DB 3D7 B35-397 8AD5A@7@E E77 435-5A7D
 N\$3KAGFF 7 B3DEA8F7 : 3@7 3EE AI @ @
 89G7
 N 3E7@F7 AI 7D 3@7 B;757EFAF7 BB7D
 BADA@A8F7 : 3@7 CE@F7 % / 4A7E
 3@1 ; @ @E
 N 3E7@F7 BB7D 3@743DB;757EFA07F 7D
 CE@F7 % / 4AF3@1 ; @ @F
 N\$G4E537 F7 ; @67 A8F7 : 3@7 9DBE1 ; F
 85' 6< ; ' 9+7 ,57+ 8+7' 662' 954 3@E 67
 A@AF7 : 3@7
 9) . /4- 9 + . ' 4* 2- 9 9 + 3 5 ; + 7
 ' & + 3H7? BFA3H35: F7 : 3@7 FAF7 4A7E
 A@F7 D@7DBE7? 4K3FF7 D73DA8F7 ? AI 7D
 + ; E ; @AD75F D78DFA89G7 EKAG8A AI
 F7 : @H@5FA@47-AI D78DFA89G7 8AD? AD
 : @D 3FA@
 N 87DBE7? 4@ F7 : 3@7 8FF7 : A7E3FF7
 7@ A8F7 AI 7DBADA@A8F7 : 3@7 A@F7 78F
 3@D9: FE67 A7DF7 E ADPBAEE 7JF @ ; @ AGF
 8A? F7 E67 B37E
 N . : 7@F7 : 3@7 ; E ; @B357 A7DF7 BAE E@B
 F7 L @ @EA@AF7 EA76 BAE@A@4AF E67E
 FAE7H7@F7 : 3@7 8A? 5A? ; @ AB

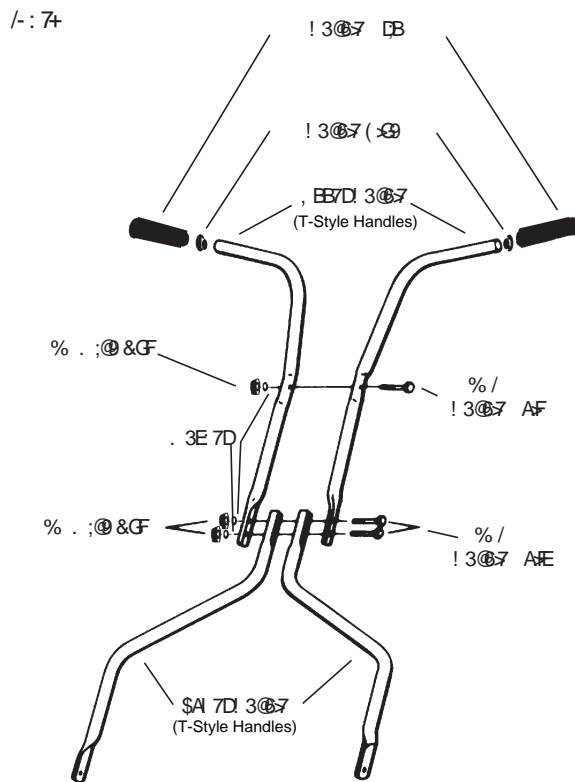

/:- 7+ = 57A)9

/:- 7+ = 4)57A)9

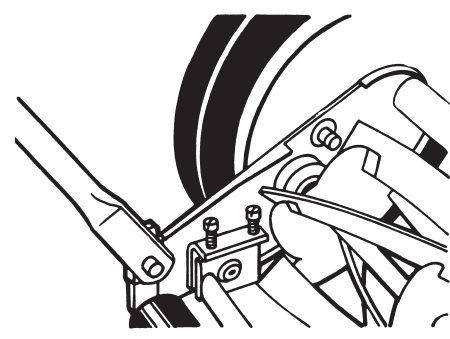
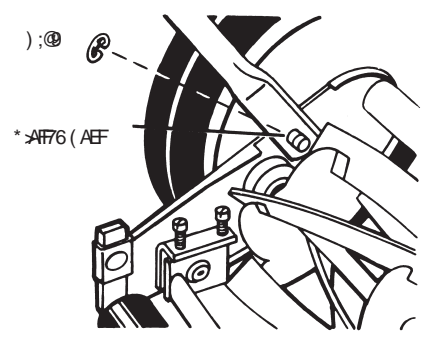

Grass Catcher Assembly Instructions

Step 1: * @BI ;D >AAB A7DAD;@A 3@5D? B5>AE76 I ;F B;7IE D7B73F8ADABBAE7 E67

Step 2: (CE I ;D ECEBAD78AFF D@G: >AAB E71 @;@A 4A7A? A8E3@+; ;E1 ;>ECEBAD78AB D;>

Step 3: * @BF A8@D76 5A7IE A7DI ;D FA5A? B77 3EE7? 4KA853F5: 7D

0AG3D7 @A D736KFA3F85: 53F5: 7DFAKAGD8I @? A I 7D

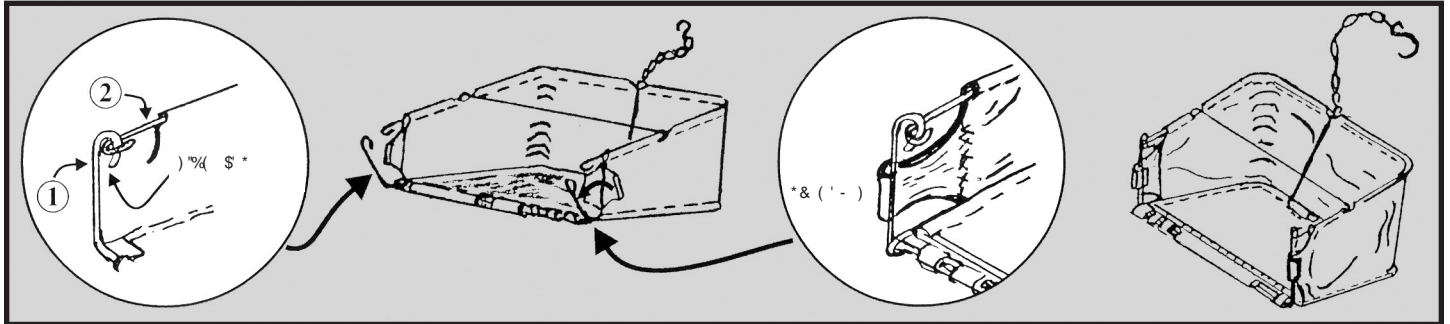

Attachment for 40cm Elite Push Reel Mower with rear roller assembly - Refer to Figure 1

Step 1:) 7? A7 E 71 ;@ @F: A6;@ F 7 D >7D4D5=7FA@ F 7 ? A 7D

Step 2:)7?AH7 F:7 DA>>7D 4D35=7F 5>3?B 3@6 D7B>357 ;F J;E; F:7 53F5:7D
:AA= ;9GD7 ;9GD7)7F3;@ 5>3?B 8AD 8GFGD7 GE7 \:7 @ AF
GE;@9 9D3EE 53F5:7D

Step 3:) 7B357 F 71 ;@ @FA@AF 7 4AF3@ D7F: F @47;@ 53D78>FA
=77BF 7 53F5: 7D: AA= 3E8E3;9: F3EBAEE47 "F? 3K47 @57EE3DK
FA 36<EFF;E3>@ 7 @387D4AF E67E3D ;@B357

Step 4:) 7B73F8ADABBAE7 E67

Step 5: +: 71 ;D 3FF 7 8A@FA8F: 7 53F5: 7D;EB3576 ;@A F 7 EA7E A8F:7
53F5: 7D: AA= ;9GD7

Step 6: F85: LECAA=3FD73DA853F5: 7DFA: 3@7 36<EF8ADKAGD: 7;9: F3@
F75: @CG7 ;9GD7

+4+7 2 ' 7+

%@ G 53D ;E DCGD76 FA3EEG? E? AAF
AB7BFA@A8KAGD? AI 7D
N+A3A6 63? 397 FAF 7? AI 7DAD5GF;@ 4267E =7B
F 7 3D73 FA4? ? AI 76 8D7 8A? 3@674DE
N. 7 EG97EF3 DAG;@ 3EB;53FA@A8A>ADG4D53@
+; EE AG6 47 3EB;76 FA3>5GF;@ EG8857E
F 7 5GF@ D7>3J7 E 3F3@ I : 77E

: 9/4- . +/- . 9' * 0 89B +49B

+; 7 GF53@47 36-GEF76 FA A8D3 5GF;@ : 7;9: F
D@7 8A? ?? FA ??

+; 7 5GF;@ : 7;9: F53@47 36-GEF76 E? BK4K
36-GEF;@ F 7 D>7D8EE? 4K #77B; @; @ F 3F
F 7 E3? 7 36-GEF? 7@? GEF47 B7DAD 76 A@4AF
E67EA8F 7? AI 7D EKAG8>AI F 7; @H05FA@
47>AI D8DFA ;9GD 8D? AD; @D 3FA@

N+A35: ;7H F 7> AI 7EF5GF;@ BAEFA@>AAE7@
3@ D? A7 F 7 @FEA@4AF E67EA8F 7 D>7D
3EE? 4K

N(AEFA@F 7 4AFF DAG: F 7 4AFA? : A7 A8F 7
B3EF5 D>7D4D5=7F3@ F 7 FAB: A7 A8F 7
? AI 7DE67 B3F) 7F9: F @FEA@4AF E67E

N+A35: ;7H F 7 : 9: 7EF5GF;@ BAEFA@>AAE7@
3@ D? A7 F 7 @FEA@4AF E67EA8F 7 D>7D
3EE? 4K

N(AEFA@F 7 4AFF DAG: F 7 FAB: A7 A8F 7
B3EF5 D>7D4D5=7F3@ F 7 4AFA? : A7 A8F 7
? AI 7DE67 B3F) 7F9: F @FEA@4AF E67E

' F 7D5GF;@ : 7;9: IE53@47 A4B; @6 4K
BAEFA@@ F 7 4AFF DAG: AF 7D A7 >A53FA@
+A35: ;7H ? 3J;? G 5GF;@ : 7;9: IE F 7
I : 77>6GF5A7D8EE? 4K53@47 ? A76 FAF 7
AF 7D BAEFA@E A@F 7 E67 B3F AD ;@
>9GD #77B; @; @ F 3FF 7 E3? 7 36-GEF? 7@?
? GEF47 B7DAD 76 A@4AF E67EA8F 7? AI 7D
EKAG8>AI F 7; @H05FA@47>AI D8DFA
>9GD

N) 7? A7 F 7 : G4 53B

N) 7? A7 F 7 3J7 @FA@F 7 ; @67 A8F 7? AI 7D
4K: A6 @ F 7 3J7 B; @B357 I ; F 7; F 7D3
EA5=7FAD88F4267 E5D1 6D7D3@ 7; F 7D3
EA5=7FAD4A1 7@ I D7@: A@F 7 @F

N(G F 7 I : 77>6GF5A7D3@ 3J7 B; @AGF
97@K3E3 G@FC@>F 7 3J7 B; @573IE F 7 E67
B3F

N) 7BAEFA@@F 7 67ED6 : A7 3@ D7B357 3@
F9: F @@FE (AEFA@ M\$AI 7EFE7F;@ (AEFA@
M%667 E7F;@ (AEFA@ MI ;9: 7EFE7F;@

5; +7(2 * + ' * 0 89B +49

+; 7 4267E: 3H 477@BD736-GEF76 478AD >73H@
F 7 85FADK

%E3;9@ 7 @F53@A55GD7EGF;@ ; @4267E F 3F3D
FAA>AAE7 ADFAA F9: F '8F;E: 3BB7@E KAGI ;>
@AF57 3 DAG: G@H7@5GFAD3 : 3B ECE ; @
? AI 7D

>36-GEF? 7@E3D? 367 8A? F 7 D73DA8F 7
? AI 7D ABBAEF 8A? F 7 43D1 ;F F 7 >A9A6753>
35: 7 @ A8F 7 5GF;@ 43D53@47 36-GEF76
E7B3D7K

EKAG8>AI F 7; @H05FA@47>AI D8DFA 89GD
8AD? AD; @D 3FA@

N+: 7 5GF;@ 43D4267 >A53F76 G@D7E 7 D7>
B7AE +; 7 8A@E5D1 E? A7 F 7 5GF7D43D
3I 3K8A? F 7 4267E I : ;> F 7 D73DE5D1 E
? A7 F 7 5GF7D43DFA 3B F 7 4267E

N 6-GEF;@ F 7 E5D1 E;E3 H7DK7@E7F
ED576GD ?? FGD@E5A@67D76 3? 3AD
36-GEF? 7@

N 78D F9: F @ @ A@ 36-GEF;@ E5D1 47 EG7 FA
>AAE7@F 7 ABBAE;@ E5D1 3@7CG>3? AG@

558+4/4- 9 + (2 * +8

+; 7 5GF;@ 43D4267 ? GEF47 ? A76 83F 7D8A?
F 7 5GF;@ D7>

N\$AAE7@4AF D73DE5D1 E7CG>K4KFGD@ F 7?
5AG@7D5A5-I ;E7

N+;9: F @4AF 8A@E5D1 E7CG>K4KFGD@
F 7? 5A5-I ;E7

#/- . 9/4/4- 9 + (2 * +8

+; 7 5GF;@ 43D4267 ? GEF47 ? A76 5AE7DFA F 7
5GF;@ D7>

N\$AAE7@4AF 8A@E5D1 E7CG>K4KFGD@
F 7? 5AG@7D5A5-I ;E7

N+;9: F @4AF D73DE5D1 E7CG>K4KFGD@ F 7?
5A5-I ;E7

. +) 1/4- ' * 0 89B +49B

N+GD@? AI 7DGBE67 6AI @

N"@7DFB757 A8B3B7D; 7 I DF;@ AD@1 EB3B7D
47H 77@F 7 5GF7D43D@ F 7 D7>4267E 3@
53D78>KFGD@F 7 D7>4267E 4K: 3@

>4267E E AG6 E;57 F 7 B3B7D7H @AF 7 7 @D
>@F A8F 7 5GF7D43D1 ;> F 7 D7>FGD@
E? AAF K

'8F 7? AI 7D 3E3@ @7D ;F7 @5GF 36-GEF? 7@
E AG6 47 ? 367 FA 3EBDABD3F E67 A8F 7 4267E
FA 3FB; @BDAB7D5GF;@ 35FA@

/- : 7+

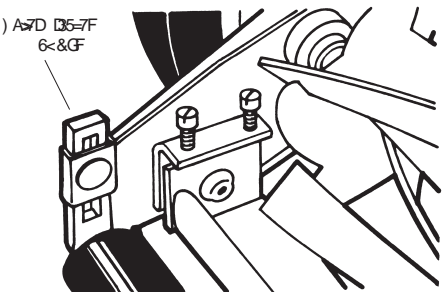

/- : 7+

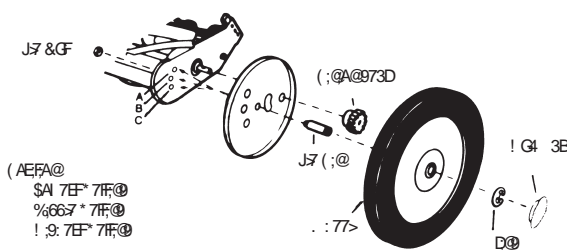

/- : 7+

D@

) 73D

6-GEF;@
* 5D1 E

".' 76+4/4- 9+): 994- (2*+8
 . : 7@F 7? A! 7D;E BDB7DK;G4D53F76 3@
 36-GE76 E 3DB7 @@@ E AG6 @AF47 @57EE3DK9AD
 E7H7B>K73IE ! A! 7H7DF7 8A>A! ;@ EF7BEI ;>
 3>A! KAGFA6AF7 ED7676G7 KAGIE783FD73FH7K
 #F7 7JB7@7
 N) 7? A7 F7 L CD@E I : 77E3@ B;@A@8A?
 4AF E67EA8F7? A! 7D D78DFA89G7
 N) 7? A7 4AF B3I ;E8A? F7 D75B@G3DEAE;@
 D7>E 38F3@ D7H7B7 F7;DBAEFA@E D78DFA
 89G7
 N) 7H7B7 F7 B357? 7@A8F7 B;@A@973IE
 N(357 F7 78FB;@A@AF7 D9: F7 @A8F7 D7>
 E 38F3@ F7 D9: FB;@A@AF7 78F7 @A8F7
 D7>E 38F) 7B357 F7 I : 77E3@ L CD@E
 N* ED736 3 F; @2K7DA83EB; @ 5A? BAG@ A@F7
 8A@7697 A8F7 D7>4367E
 N 6-GEFF7 5GF7D43DEA F 3FF 7 5GF7D43D4367
 : 3E>@: F4GF8D 5A@B5F ;F F7 D7>4367E
 35DAEE F7 8>A! ;6F A8F7 5GF7D43D D78DFA
 89G7 \$# A@FAH7D9: F7@F7
 36-GEF@ E5D1 E 3EF;E5AG6 63? 397 F7
 5GF7D43D AF E5D1 E? GEF47 F9: FA@F7 8@>
 36-GEF7 7@
 N(GE F7? A! 7D435H 3DB A@B E? AAF EG8857
 EG6: 3E3 E67I 3> ADB3H76 6D7H 3K
 A@@7 FA6AF;EG@>F7 D7>4367E D78F7
 D73FH7K8D7 3@ 8A@7697 A8F7 5GF7D43D
 4367;EBA>E 76
 N) 7? A7 I : 77E D7H7B7 B;@A@3@ B3I ;E EA
 F 3FF 7 47H776 7697 A8F7 B3I >EA@F7 D9: F
 \$# 73@3@9D@; @ 5A? BAG@ AD
 674DE8A? F7 5GF7D43D4367 D7>4367E
 B;@A@3@ B3I ;E \$G4D53F 3J7 3@ B;@A@ ;F
 3>@: F8? A8I : 77>473D@ 9D73E7 3@ D7B357
 I : 77E3@ L CD@E
 & + 'F;ED75A? ? 7@76 FA GE7 3@; @GEFB>AD
 H>H7 3EB; @ 5A? BAG@ 47F 77@ 9CF
 + ;E;EG3>K3H>347 3F3@ @GEFB>AD
 3GA? AH7 EGBBK EAD

!-: 7+

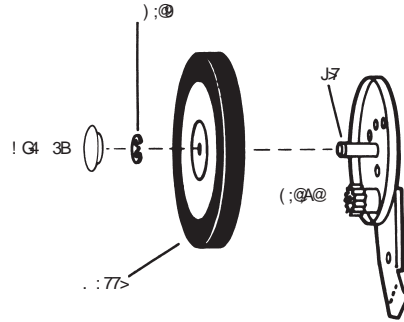

!-: 7+

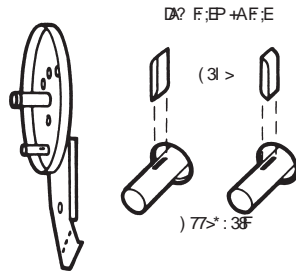

!-: 7+

6-GEF@
 * 5D1 E

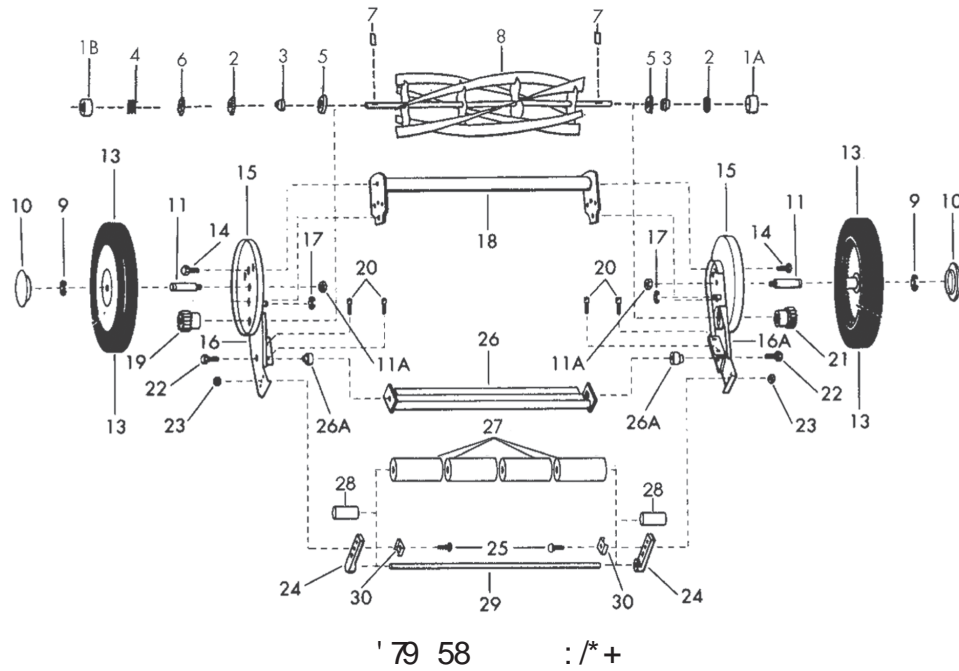

' 79 58 :/*+

		5*
< 5	' 79 +8) 76954	5
	3> GB	
	3> GB	
	3> 73D@ EE? 4K	
	73D@ A@	
	* BD@ D7>36-GE? 7@	
	GEF. 3E 7D	
	73D@. 3E 7D	
) 3F5: 7F(3I >	
) 77> EE? 4K =7K	
	L Q ;@ ?? " ?? F;5=	
	! G4 3B	
	J7	
	! 7J &GF %	
	. : 77>3@+;D EE? 4K	(
	! 7J! 736 AF% /	
	A7D (-37	
	\$78F* ;67 (-37	
) ;9: F* ;67 (-37	

		5*
< 5	' 79 +8) 76954	5
	L Q ;@ ?? " ?? F;5=	
	+ADEA@ 3D	
	\$78F ;@A@ 73D	
	6-GE? 7@* 5D1 ;@ ;@	
) ;9: F ;@A@ 73D	
	GF7D 3D AF% /	
	. ;@ &GF %	
) A7D B35=7F	
	3DDB97 AF% /	
	GF7D 3D	
	GF7D 3D' FG6	
	;@> ;@AE	
) A7D' 75FA@	
) A7D' B857D	
) A7D+G47	
	A? B717) A7D EE? 4K	
) A7D B35=7F -3? B	

Customer Responsibilities

→ 3KEGE7 53D1 : 7@AB7B3F@ KAGD3I @? AI 7D
 3@ =77B573DA8? AH@ B3DE HA6 EFD; @ AD
 D@ @ @ ; @A EA;6 A475EAD674DE ;@F: 7 3D73 FA
 47 ? AI 76 7 EGD F:7 ? AI 7DE573@3@ 8> AI
 3 D'9G3D? 3;@7 @@7 E5: 76G7 ;@AD7DA BDAH67
 785;7 @3@ E88 AB7B3FA@ I 7>53D76 8AD3I @
 ? AI 7D ;>3EF-A@ 3@ AB7B3F ? AD 785;7 @K