

A

B

C

D

E

F

55	220015001	SCERW,M6X1.0X16 T25 HEAD	1
56	220016001	SCERW,M5.0X1.0X25 T25 HEAD	1
57	220126001	SCERW,M5.0X1.0X10 CROSS HEAD	3
58	210014013	BEARING,6300Z	1
59	320117001	FLANGER WASHER	1
60	410153001	PLASTIC,GUIDE	1
61	330023001	STAMPING, BLADE	1
62	220172001	SCERW, ST4.0X14 CROSS HEAD	2
63	220122001	SCERW,M5.0X0.8X12 CROSS HEAD	3
64	120009013	STRING ASSEMBLY	1
65	130003013	BATTERY,56V,4.0AH	1
66	190001014	CHARGER,56V,2.0AH	1

ITEM	P/N	PART DESCRIPTION	QTY
1	410060001	PLASTIC,LEFT HOUSING COVER CAP	1
2	430016001	SPONGE 1	2
3	430017001	SPONGE 2	2
4	410034013	PLASTIC,LEFT HOUSING	1
5	220044001	SCREW,ST3.5X10	4+2
6	330020001	STAMPING,NUT M5.0X0.8	4
7	410022001	PLASTIC,PLATE FOR FIXING WIRE	1
8	410164013	PLASTIC, BATTERY RELEASE CAP	1
9	230005001	SPRING FOR BATTERY RELEASE CAP	1
10	410026001	PLASTIC,BATTERY TERMINAL HOLDER	1
11	670004001	HEAT SHRINKABLE TUBE 6MM	40MM
12	670003001	HEAT SHRINKABLE TUBE 3.5MM	20+40MM
13	410128013	PLASTIC, BATTERY RELEASE BUTTON	1
14	320050001	SHAFT,DIA 3.0X41 MM	1
15	230004001	SRPING FOR BATTERY RELEASE LEVEL	1
16	610014001	MAIN CONTROL PCBA	1
17	410035013	PLASTIC,RIGHT HOUSING	1
18	410066001	PLASTIC,RIGHT HOUSING COVER CAP	1
19	220001001	SCREW ,ST4.0X15.0 T25 HEAD	5+6
20	410064001	PLASTIC,OUTPUT TUBE FIX	1
21	220043001	SCREW,M5X0.8X26 CROSS HEAD	4
22	420005001	RUBBER, SLEEVE	1
23	310005001	DIE CASTING,OUTPUT TUBE JOINT	1
24	220121001	SCREW, M4X0.7X18 CROSS HEAD	2
25	240107001	WASHER 4MM	2
26	220019001	SCREW,M6.0X1.0.25 T25 HEAD	1
27	220070001	NUT,M6X1.0	1
28	220003002	SCERW,M4.0X12 T25 HEAD	1
29	410043013	PLASTIC ,LEFT HANDLE HOUSING	1
30	620001001	MICRO-SWITCH	1
31	410065013	PLASTIC,TWO SPEED GOVERNING LEVEL	1
32	230008001	SRPING,SAFRTY LOCK SPRING	1
33	410045013	PLASTIC,LOCK LEVEL	1
34	620002001	SWITCH,VARIABLE SWITCH	1
35	410046013	PLASTIC,TRIGGER	1
36	230007001	SPRING, SPRING FOR TRIGGER	1
37	630008001	LEAD WIRE ,FRONT HANDLE SINGLE ASSEMBLY	1
38	260010001	PIN, 2.8X10	1
39	410042013	PLASTIC ,RIGHT HANDLE HOUSING	1
40	220043002	SCREW,M5X0.8X35 T25 HEAD	4
41	410040001	PLASTIC, LOOP HANDLE SUPPORT	1
42	420004001	RUBBER, INNER SPOOL CAP	1
43	410041001	PLASTIC,O-TIP HANDLE COVER	1
44	220071001	NUT,M5X0.7	4
45	310019001	ALMINUM TUBE	1
46	630018001	ELECTRIC WIRE	1
47	410138013	PLASTIC,PRESSING PLATE	1
48	230019001	SPRING,SPRING FOR PRESSING PLATE	1
49	220003001	SCERW,M4X15 T25 HEAD	4
50	410136013	PLASTIC,MOTOR HOUSING COVER	1
51	240110001	SNAP RING,DIA17	1
52	660012001	56V MOTOR	1
53	410137001	PLASTIC,6GROOVE FOR ELECTRIC WIRE	1
54	320116001	DIE CASTING,MOTOR HOUSING	1

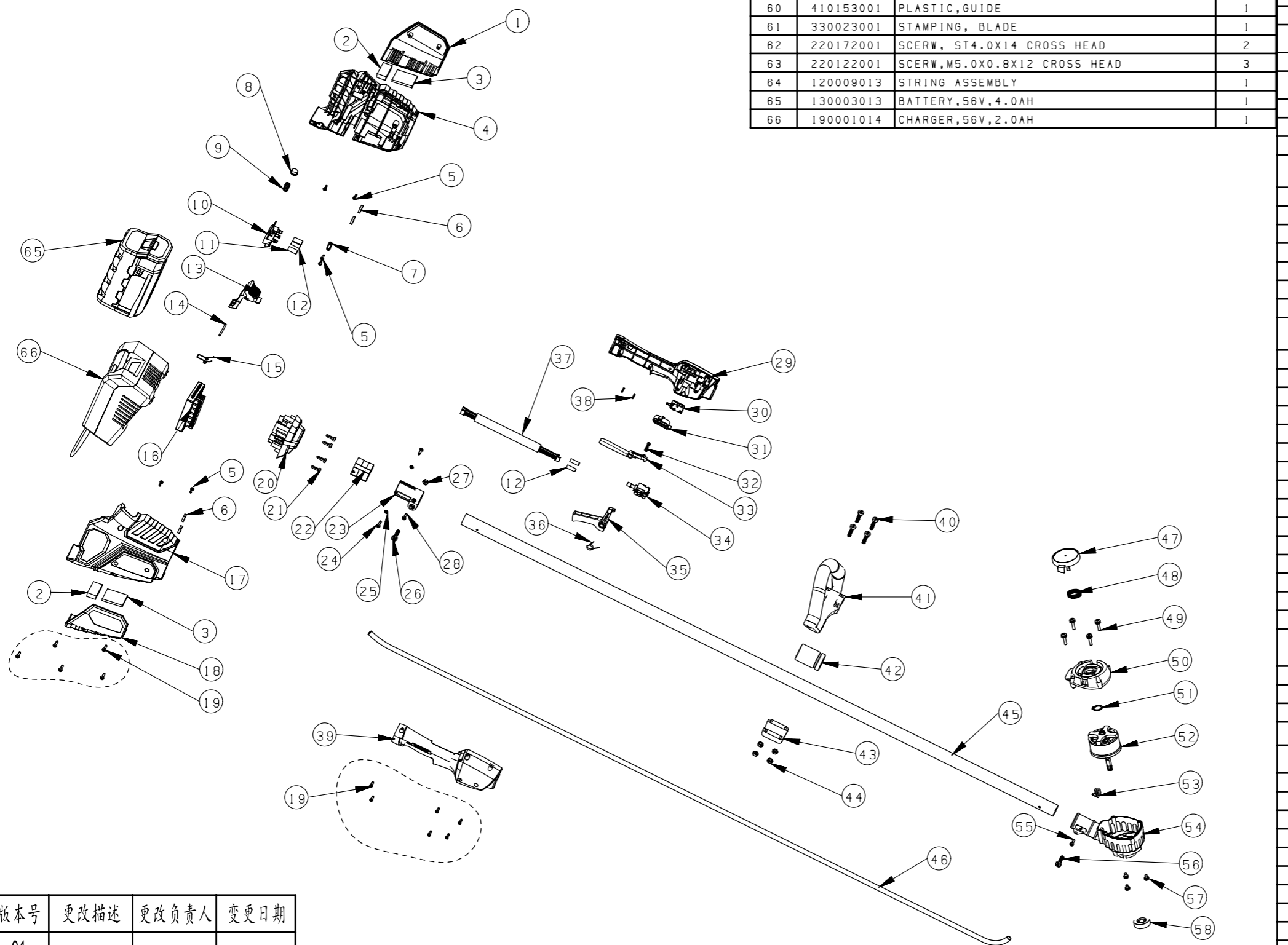

版本号	更改描述	更改负责人	变更日期
01			

投影 PROJECTION		规格 SPEC	编号 P/N	090006013		
设计 DR.		名称 NAME	重量	比例	版本号	
校对 CK.		56V FRONT LINE TRIMMER FOR GSC			01	
审批 APPR.		备注 REMARK	共 页 TOTAL P. 第 页 PAGE			
			TPT 浙江卓远机电科技有限公司			